

MASTERBUILT®

EST. 1973

Welcome to the family. Let's get started.

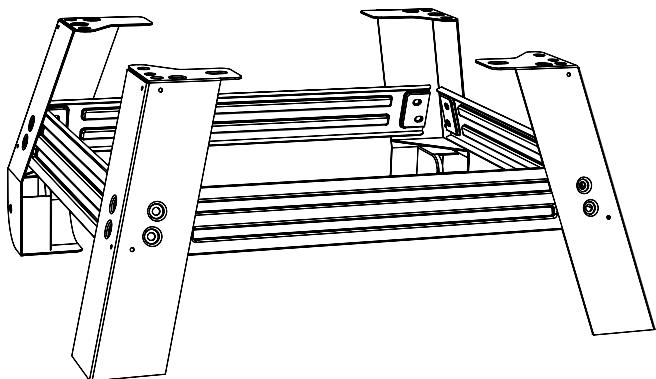

Smoker Leg Kit with Wheels

Manual applies to the following model number(s)

MB20101114

Manual Code: 9807170033 170728-GSB



WARNING



CALIFORNIA PROPOSITION 65

THIS PRODUCT CONTAINS CHEMICALS KNOWN TO THE STATE OF CALIFORNIA TO CAUSE CANCER, BIRTH DEFECTS OR OTHER REPRODUCTIVE HARM.



WARNING



- TO AVOID PERSONAL INJURY AND/OR PROPERTY DAMAGE, PLEASE READ AND/OR FOLLOW ALL OF THESE INSTRUCTIONS BEFORE ASSEMBLING AND OPERATIONS
- USE LEGS ON STABLE AND LEVEL SURFACE ONLY

Tools needed for assembly:

Phillips Head Screwdriver
Adjustable Wrench

Master it. Masterbuilt.

PARTS LIST

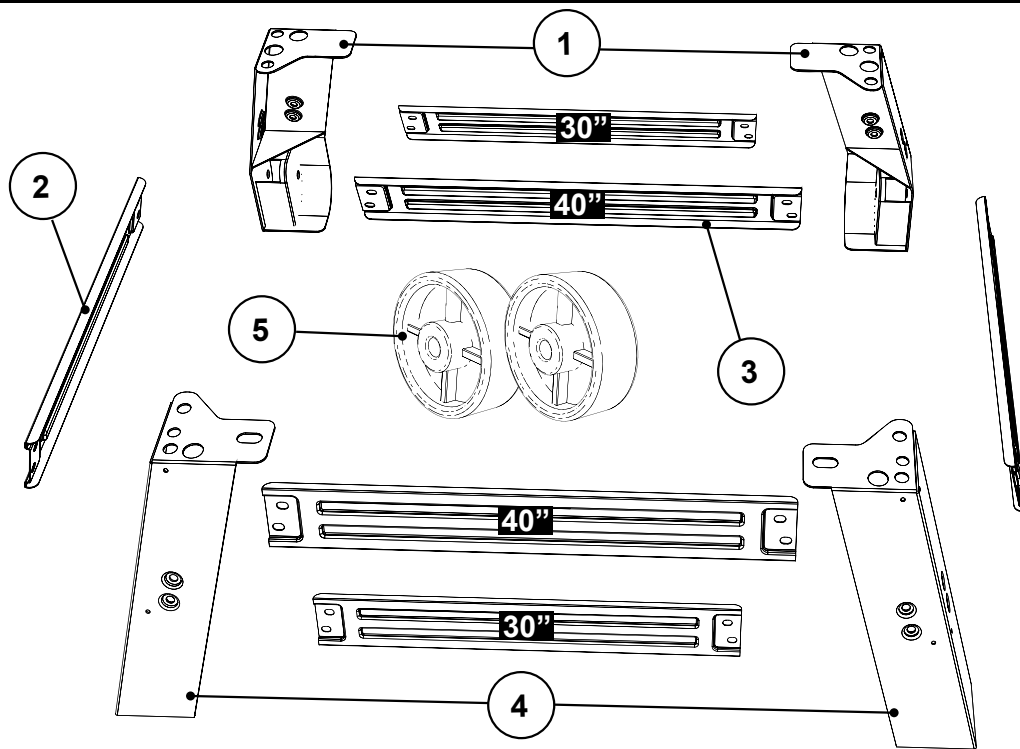

ITEM NO.	QTY.	DESCRIPTION
1	2	REAR LEGS
2	2	SIDE BRACES
3	4	FRONT AND BACK BRACES
4	2	FRONT LEGS
5	2	WHEELS

HARDWARE



A
M6 X 12
Qty-16



B
M6 Flange Nut
Qty-16



C
M6 Flat Washer
Qty- 6



D
M10 Flat Washer
Qty-4



E
M10 X 30 Bolt
Qty-2



F
Wheel Pin
Qty-2



G
Wheel Clip
Qty-2



DO NOT RETURN TO RETAILER
 For Assembly Assistance, Missing or Damaged Parts
 Call: MASTERBUILT Customer Service at 1-800-489-1581.
*Please have model number and serial number
 available when calling.*



ASSEMBLY

INSTRUCTIONS FOR MODEL SHOWN BELOW

*Re-Use Hardware
From Smoker On
The Front Legs.*

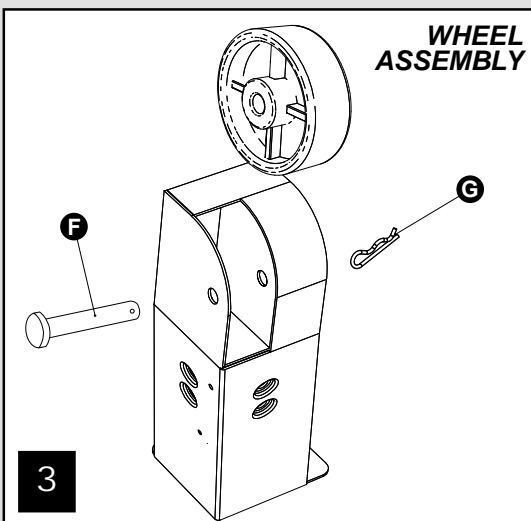
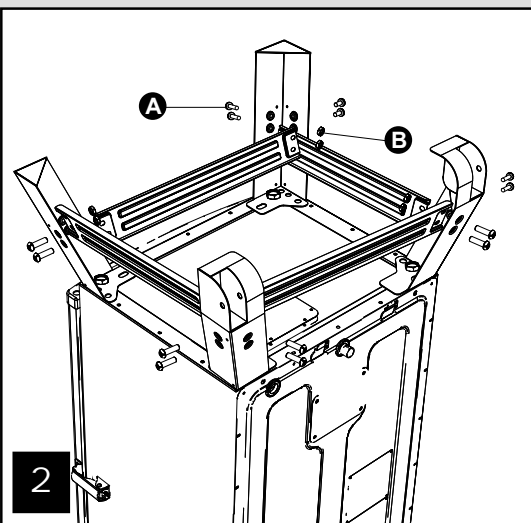
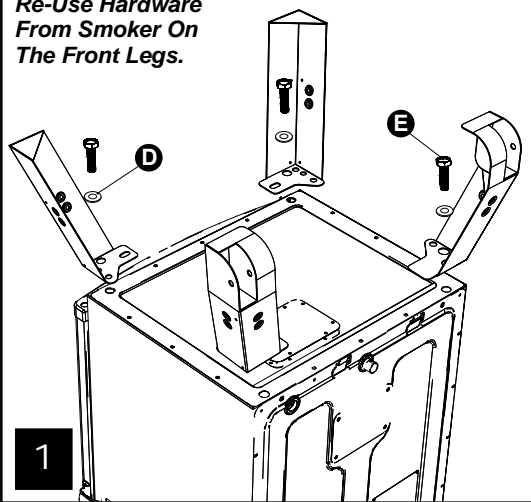

INSTRUCTIONS FOR MODEL SHOWN BELOW

*Re-Use Hardware
From Smoker On
The Front Legs.*

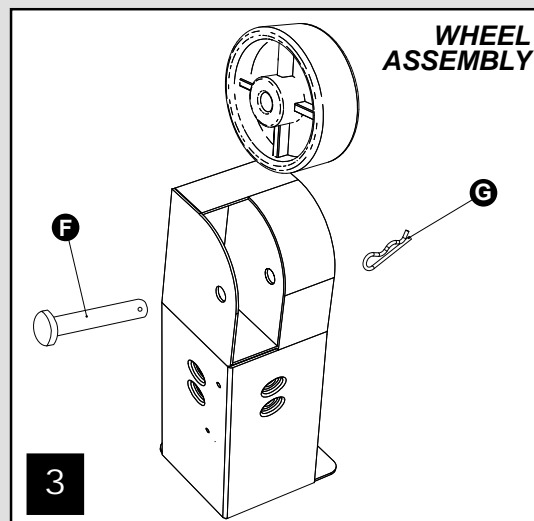
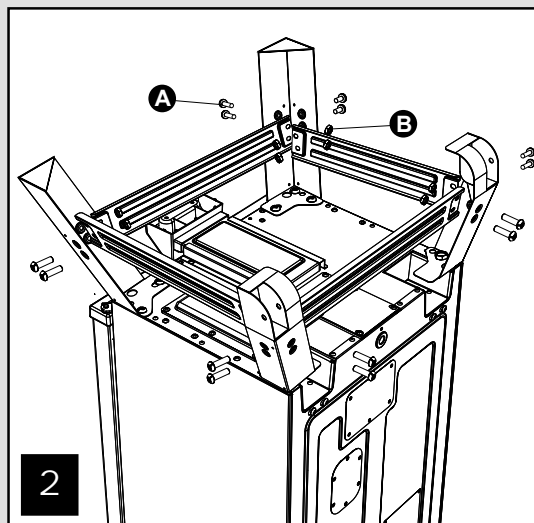
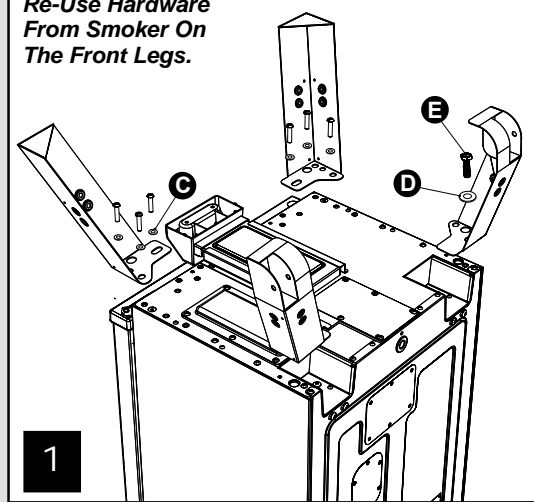

MASTERBUILT®

EST. 1973

Rest assured, we're here to help.

Customer Service masterbuilt.com/contact

Masterbuilt Manufacturing, LLC
1 Masterbuilt Court | Columbus, GA | 31907

@masterbuilt



1.800.489.1581

www.masterbuilt.com

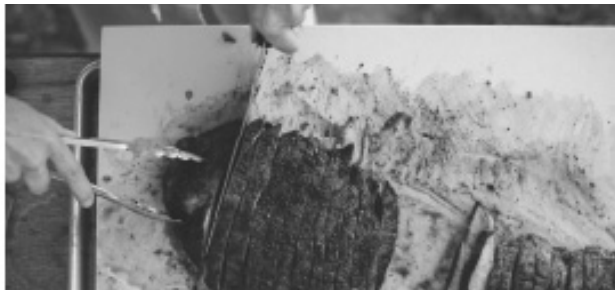

MASTERBUILT®

EST. 1973

Bienvenue à la famille. Commençons.

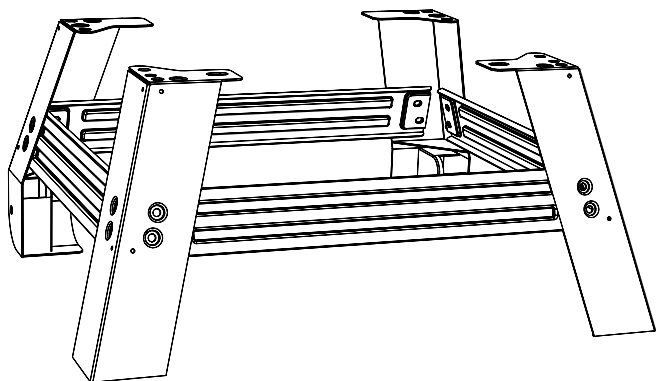

Kit jambe fumeur avec roues

Le manuel s'applique aux numéros de modèle suivants

MB20101114



AVERTISSEMENT



PROPOSITION 65 DE L'ÉTAT DE CALIFORNIE

CE PRODUIT CONTIENT DES SUBSTANCES CHIMIQUES RECONNUS PAR L'ÉTAT DE CALIFORNIE COMME CAUSANT LE CANCER, DES ANOMALIES CONGÉNITALES ET D'AUTRES ANOMALIES DE LA REPRODUCTION.



AVERTISSEMENT



- POUR ÉVITER LES BLESSURES ET LES DOMMAGES MATÉRIELS, VEUILLEZ LIRE ET SUIVRE TOUTES CES CONSIGNES AVANT DE COMMENCER L'ASSEMBLAGE ET D'EFFECTUER LA MISE EN SERVICE
- UTILISER LA BASE UNIQUEMENT SUR UNE SURFACE PLANE ET STABLE

Outil requis pour l'assemblage :

Tournevis à pointe cruciforme
Clé à molette

Master it. Masterbuilt.

LISTE DES PIÈCES

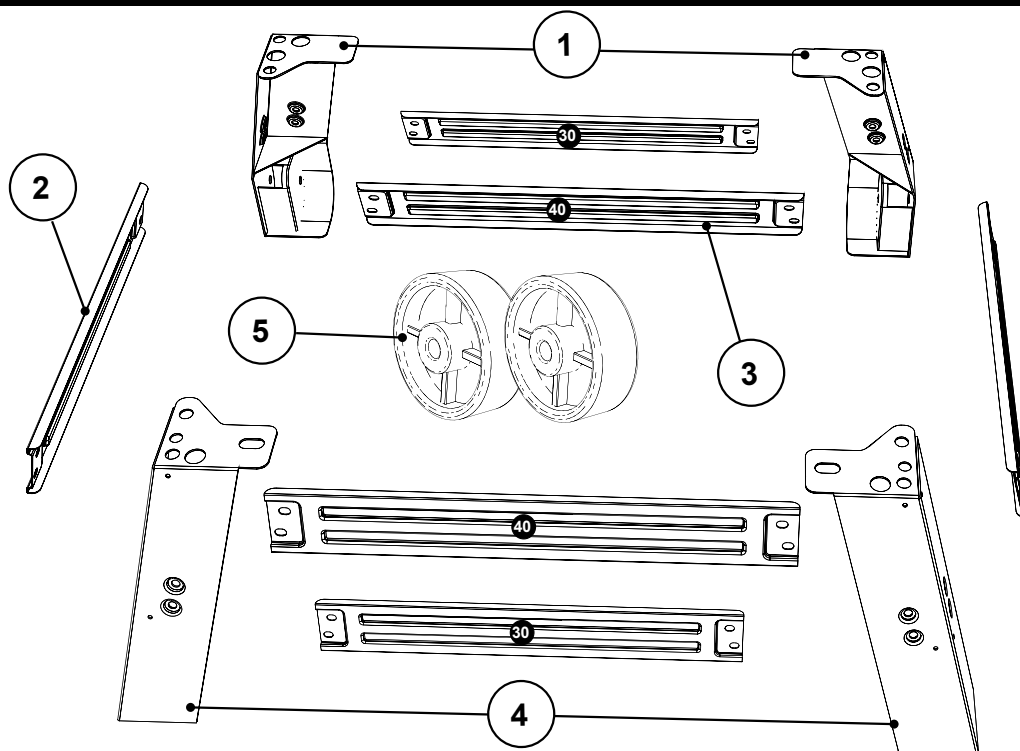

NUMÉRO D'ARTICLE	QUANTITÉ	DESCRIPTION
1	2	PIEDS ARRIÈRE
2	2	RENFORTS LATÉRAUX
3	4	RENFORTS AVANT ET ARRIÈRE
4	2	PIEDS AVANT
5	2	ROUES

LISTE DES PIÈCES DE QUINCAILLERIE

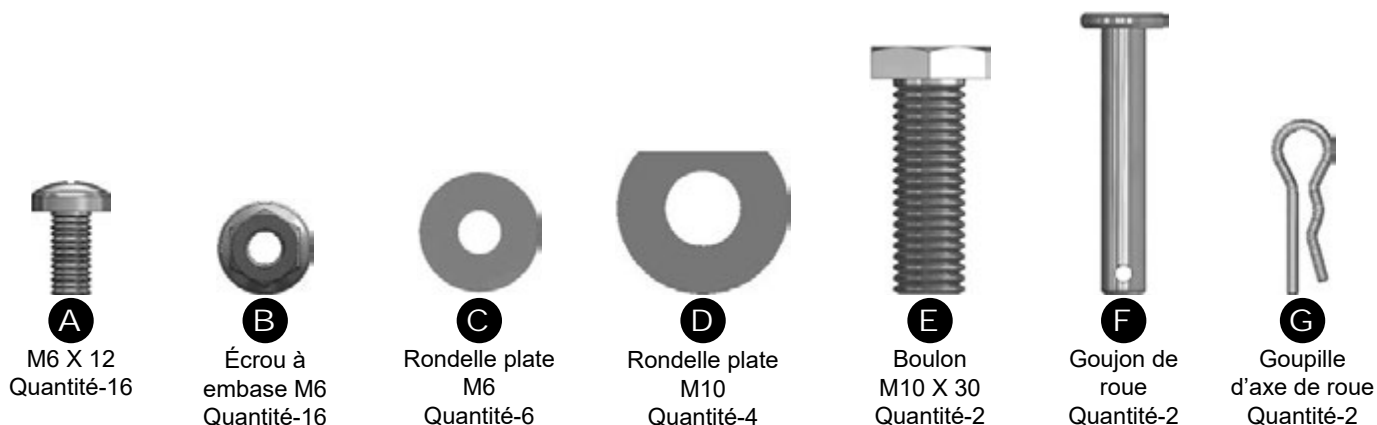

NE PAS RENVOYER AU DÉTAILLANT

Pour obtenir de l'aide pour l'assemblage de l'appareil ou pour signaler des pièces manquantes ou défectueuses, veuillez appeler le service après-vente MASTERBUILT au 1-800-489-1581.

Veuillez avoir à disposition le numéro de modèle et le numéro de série lors de l'appel.

ARRÊTER

ARRÊTER

ASSEMBLAGE

INSTRUCTIONS POUR LES MODÈLES MONTRÉS CI-DESSOUS

Utiliser les
mêmes pièces de
quincaillerie du
fumoir pour monter
les pieds avant.

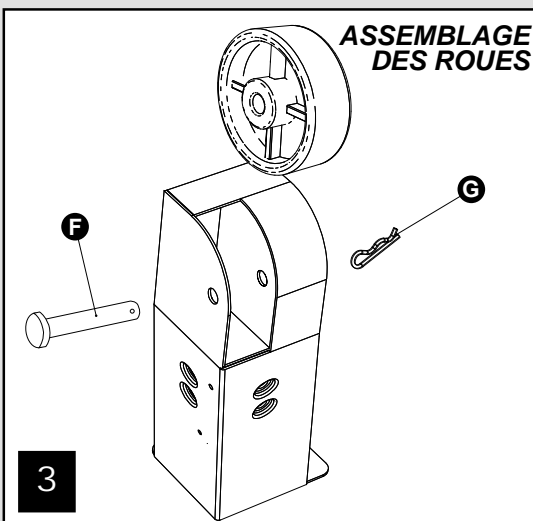
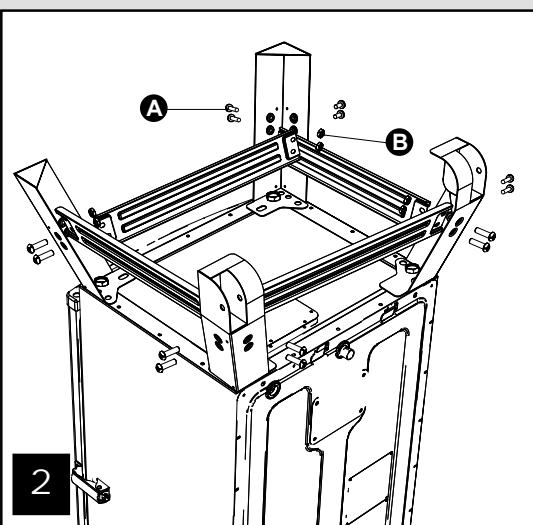
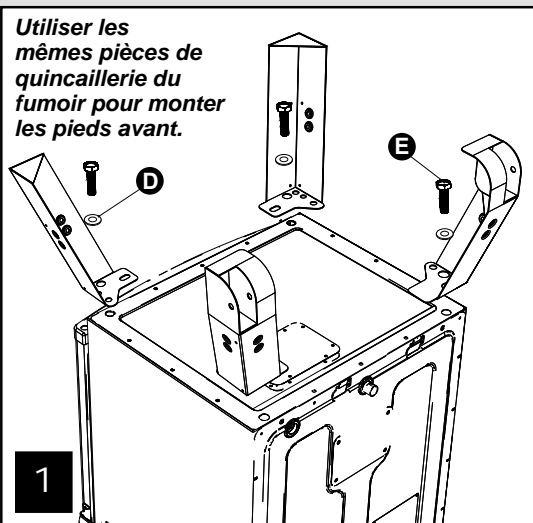

INSTRUCTIONS POUR LES MODÈLES MONTRÉS CI-DESSOUS

Utiliser les
mêmes pièces de
quincaillerie du
fumoir pour monter
les pieds avant.

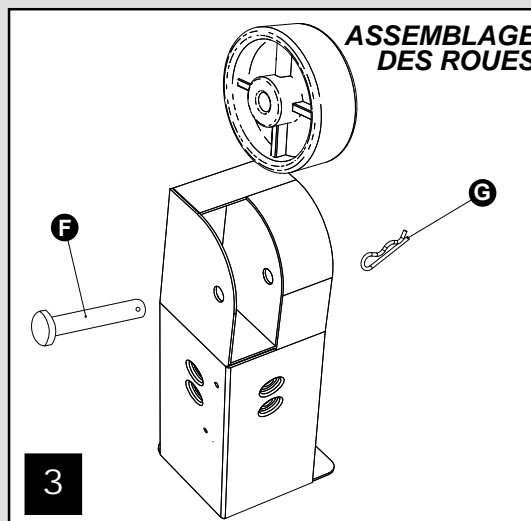
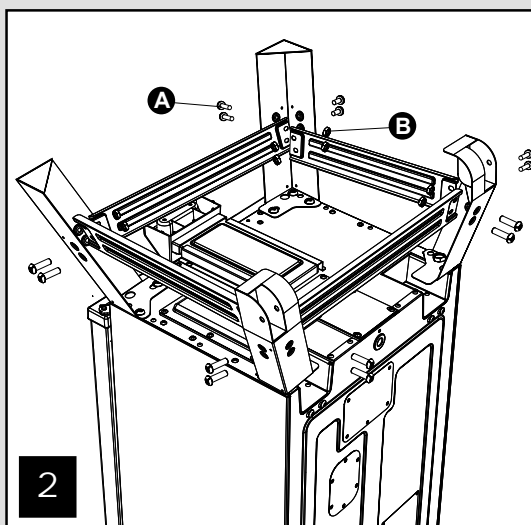
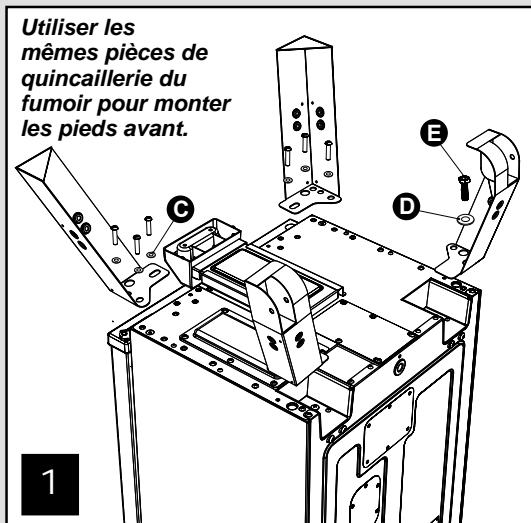

MASTERBUILT®

EST. 1973

Soyez assurés, nous sommes là pour vous aider.

Service à la clientèle

masterbuilt.com/contact

Masterbuilt Manufacturing, LLC
1 Masterbuilt Court | Columbus, GA | 31907

@masterbuilt



1.800.489.1581

www.masterbuilt.com

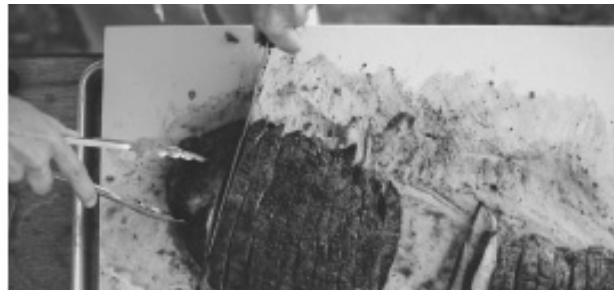

MASTERBUILT®

EST. 1973

Bienvenido a la familia. Empecemos.

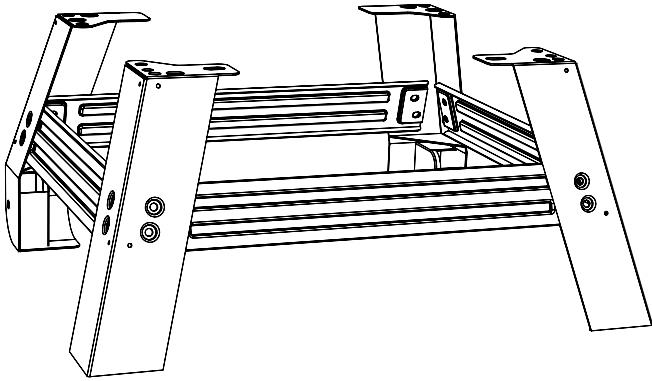

Kit pierna fumador con ruedas

El manual se aplica a los siguientes números de modelo

MB20101114



ADVERTENCIA



PROPUESTA 65 DE CALIFORNIA

ESTE PRODUCTO CONTIENE SUSTANCIAS QUÍMICAS QUE EL ESTADO DE CALIFORNIA COMO CAUSANTE DE CÁNCER, DEFECTOS DE NACIMIENTO Y OTROS DAÑOS REPRODUCTIVOS.



ADVERTENCIA



- PARA EVITAR LESIONES PERSONALES Y/O DAÑOS A LA PROPIEDAD, SÍRVASE LEER Y/O SEGUIR TODAS ESTAS INSTRUCCIONES ANTES DE ENSAMBLAR Y OPERAR
- USE LAS PATAS EXCLUSIVAMENTE EN UNA SUPERFICIE ESTABLE Y NIVELADA

Herramientas necesarias para el ensamblaje:

Destornillador de cruz

Llave ajustable

Master it. Masterbuilt.

LISTA DE PARTES

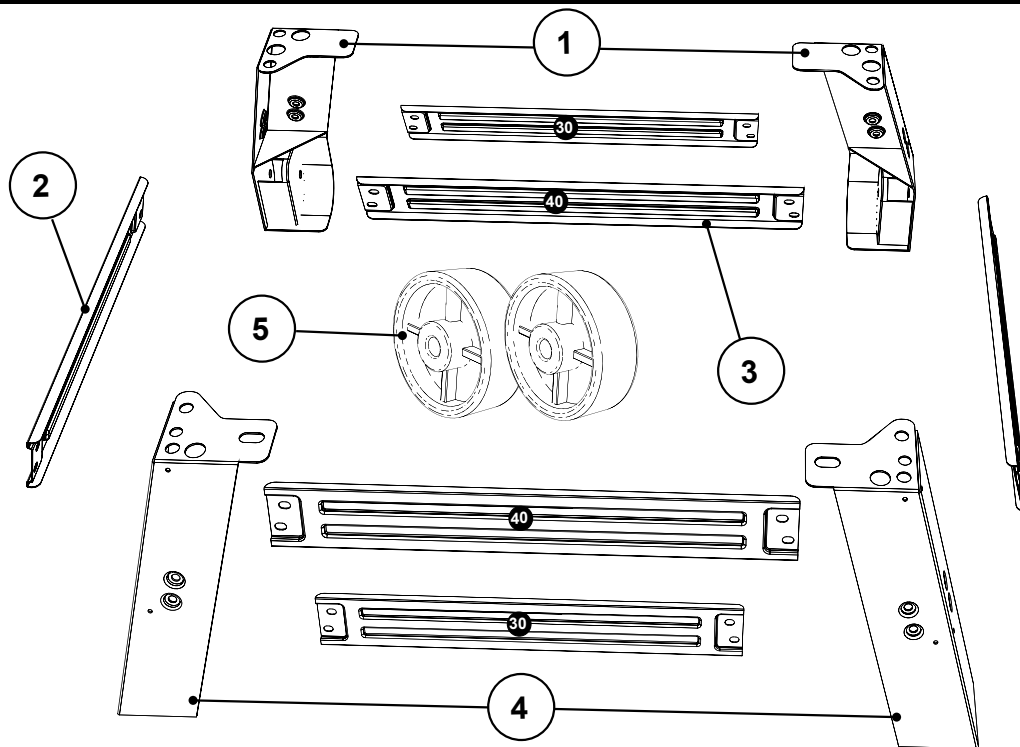

NO. DE ÍTEM	CANTIDAD	DESCRIPCIÓN
1	2	PATAS POSTERIORES
2	2	SOPORTES LATERALES
3	4	SOPORTES DELANTEROS Y POSTERIORES
4	2	PATAS DELANTERAS
5	2	RUEDAS

ACCESORIOS

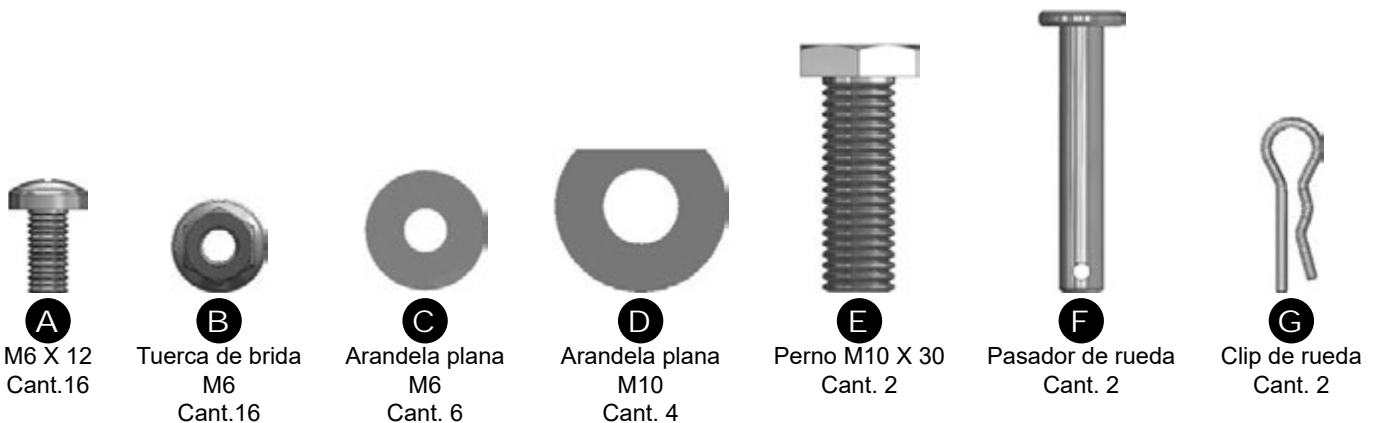

NO DEVUELVA AL ESTABLECIMIENTO MINORISTA

Para asistencia en el ensamblaje, partes faltantes o dañadas, llame al:
Departamento de Servicio al Cliente de
MASTERBUILT al 1-800-489-1581.

PARE

PARE

Tenga a la mano el número de modelo y el número de serie cuando llame.

ENSAMBLAJE

INSTRUCCIONES PARA MODELOS MOSTRADOS A CONTINUACIÓN

Reutilice los
accesorios del
ahumador en las
patas delanteras.

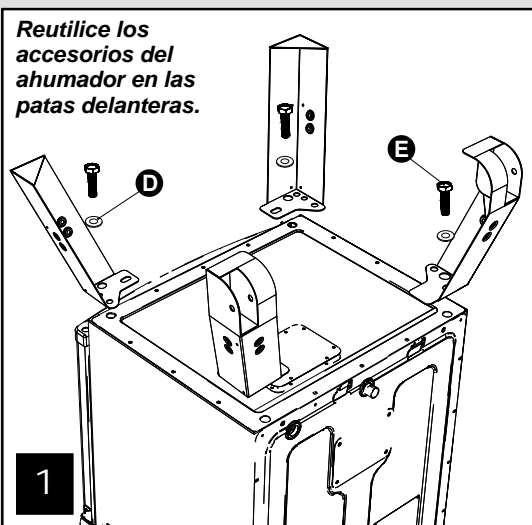

INSTRUCCIONES PARA MODELOS MOSTRADOS A CONTINUACIÓN

Reutilice los
accesorios del
ahumador en las
patas delanteras.

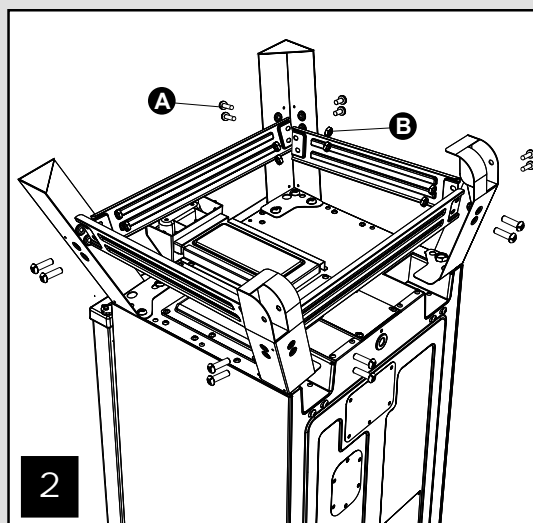
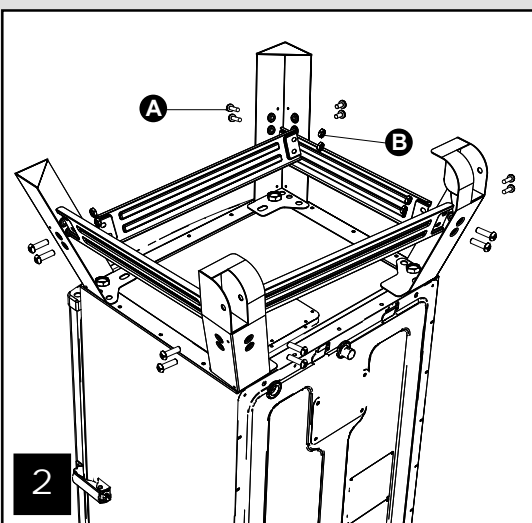
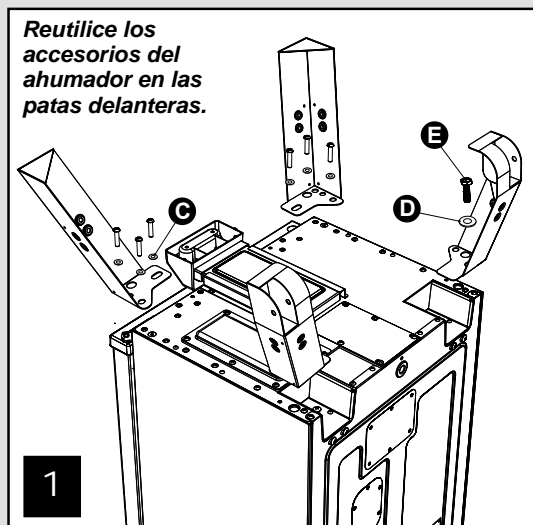

ENSAMBLAJE DE LA RUEDA

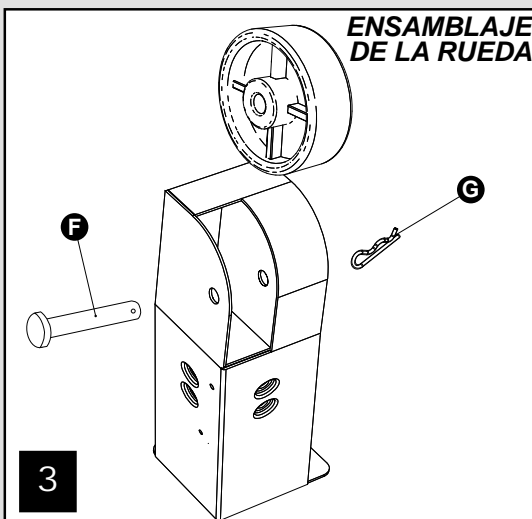

ENSAMBLAJE DE LA RUEDA

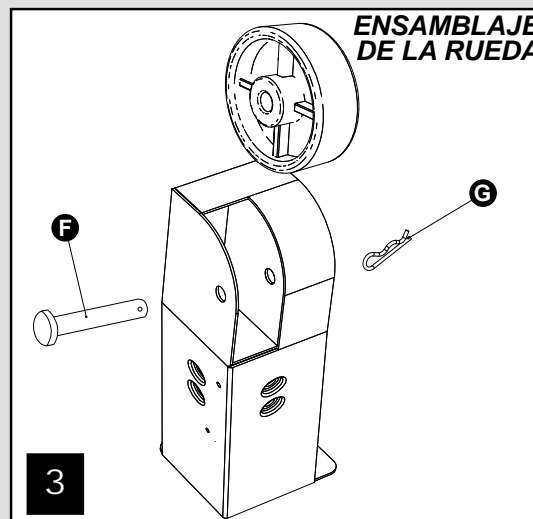

MASTERBUILT®

EST. 1973

Tenga la seguridad de que estamos aquí para ayudarle.

Servicio de atención al cliente

masterbuilt.com/contact

Masterbuilt Manufacturing, LLC
1 Masterbuilt Court | Columbus, GA | 31907

@masterbuilt



1.800.489.1581

www.masterbuilt.com

