

MASTERBUILT®

Fan Tube Kit Instruction Sheet

Digital Charcoal Smoker CS40G1DW



CAUTION



- Always remove plug from outlet before servicing your smoker.
- Make sure your smoker has fully cooled to avoid burns.
- Some components may have sharp edges. Use caution to avoid injury.

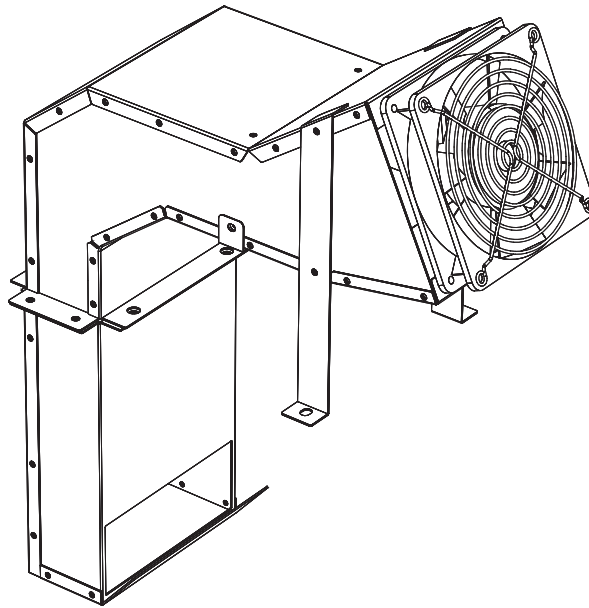

Tools Needed:
Phillips Head Screwdriver

INSTALLATION:

- Remove the doors and all the internal contents.
- Rotate the smoker legs up.
- Follow steps (1-9) to replace your fan tube kit.

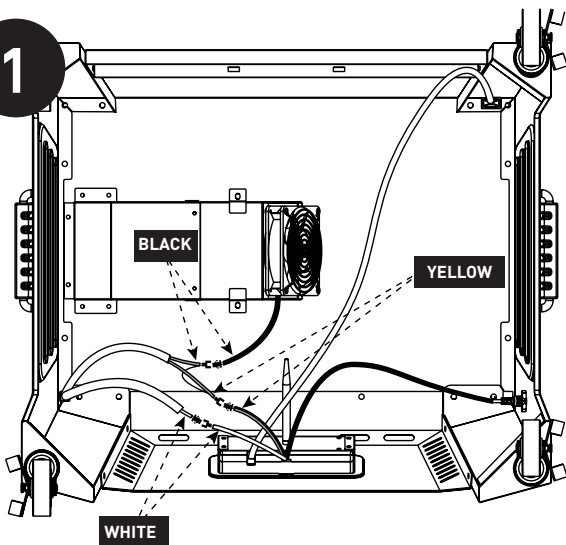

Disconnect all wires from fan and controller.

2

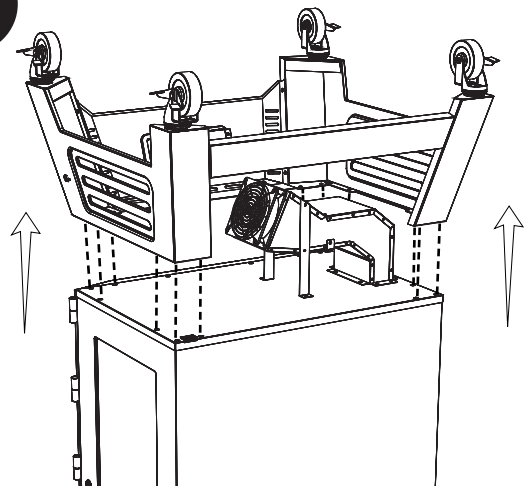

Remove the Legs, Rear Brace and Casters.

3

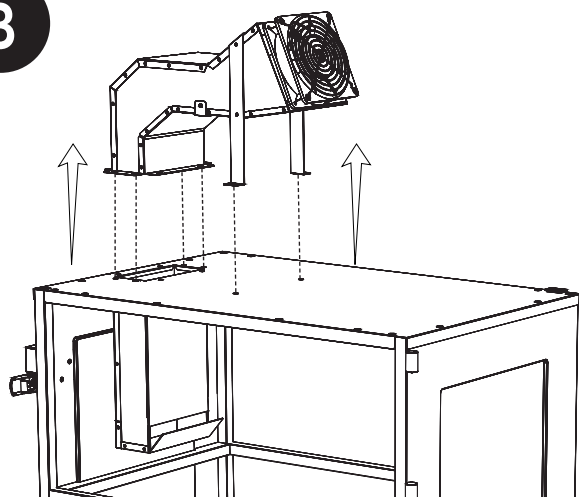

Remove outer fan assembly from smoker body.

4

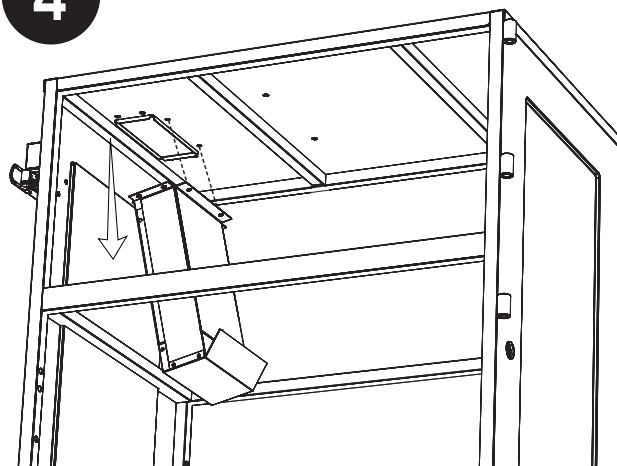

Remove the inner fan tube assembly.

INSTALLATION:

5. Replace the inner fan tube assembly (see step 4).
6. Replace the outer fan assembly (see step 3).
7. Replace the Legs / Brace / Casters assembly (see step 2).
8. Reconnect all wires to the controller and fan (see step 1).
9. Rotate your smoker to upright position and return the internal contents.

Customer Service

masterbuilt.com/contact-us
masterbuilt.com/warranty
masterbuilt.com/collections/parts

@masterbuilt



masterbuilt.com

